

USER MANUAL

ORIENT BLADELESS FAN



switch to smart

Fans • Home Appliances • Lighting • Switchgear

Orient Electric Limited

(a CK Birla Group company)
240, Okhla Industrial Estate, Phase III
New Delhi-110020

Orient Helpline no.: 1800 103 7574 (Toll Free)

Email: customer.connect@orientelectric.com

Website: www.orientelectric.com

Follow us on:     

Shop Online: www.orientelectricshop.com

Orient Helpline no.:
1800 103 7574 (Toll Free)

Safety Instructions

- Carefully read the instructions before operating the unit.
- This appliance is for indoor use only.
- Rating: This unit must be only connected to a 220-240 V / 50 Hz earthed outlet.
- Installation must be in accordance with regulations of the country where the unit is used.
- If you are in any doubt about the suitability of your electrical supply have it checked and, if necessary, modified by a qualified electrician.
- This fan has been tested and is safe to use. However, as with any electrical appliance - use it with care.
- Disconnect the power from the unit before dismantling, assembling or cleaning the unit.
- Avoid touching any moving parts of the appliance.
- Never insert fingers, pencils or any other objects through the guard.
- This appliance can be used by children aged from 8 years and above and persons with reduced physical, sensory or mental capabilities or lack of experience and knowledge if they have been given supervision or instruction concerning use of the appliance in a safe way and understand the hazards involved. Children shall not play with the appliance. Cleaning and user maintenance shall not be made by children without supervision.
- Do not clean the unit by spraying it or immersing it in water.
- Never connect the unit to an electrical outlet using an extension cord. If an outlet is not available, one should be installed by a qualified electrician.
- Never operate this appliance if the unit, cord or plug is damaged. Ensure the power cord is not stretched, exposed to sharp object/edges, or routed under the unit.
- Only use the supplied power adaptor. Should it require replacement, only use a genuine adaptor recommended by the manufacturer.
- Any service other than regular cleaning should be performed by an authorized service representative. Failure to comply could result in a voided warranty.
- Do not use the appliance for any purpose other than for its intended use.
- Never use the plug as a switch to start and turn off the fan. Use the provided power button located on the control panel.
- Always place the unit on a dry and stable surface. Do not move or tilt the unit.
- High Velocity fans are designed to create rapid air movement, therefore make sure the fan is not placed near curtains or any objects that may be drawn into the fan inlet.
- The appliance should not be installed in laundry or wet rooms.
- Do not use this unit in environments with flammable and explosive gases.
- Avoid keeping the unit in direct sunlight for a long period of time.
- The remote contains a lithium battery, keep out of reach of small children. Seek Medical advice if swallowed.
- Remove the battery from the remote before storage, or if exhausted to prevent leakage.

Energy Saving and Unit Safety Protection Tips

- Do not cover or restrict the airflow. Do not use in dusty environment.
- For maximum performance the minimum distance from a wall or objects should be 50cm.

Warning: To reduce the risk of fire or electrical shock, DO NOT USE THIS FAN with any SOLID STATE Speed Control Device or any variable speed controllers.

Features

- Slim design takes minimal space
- High Speed Motor with 3 Fan Speed Settings
- Swing Function
- 7.5 hour standby timer
- Remote Control allowing all functions to be changed
- Built in ambient light

Diagram

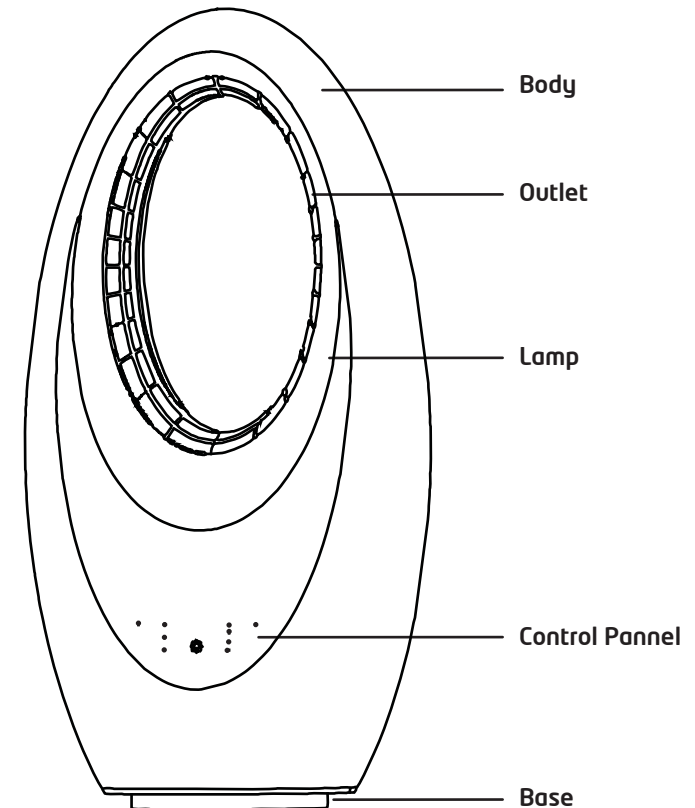

Operation

Your fan may be operated by using either the manual controls located on the front of the fan or by your remote control.

Control Panel and Settings



1. ON/OFF Button

Used to turn the bladeless fan ON and OFF.

2. SWING Button

Press to turn the Swing function on and off. When it is operational the horizontal direction of the airflow is slowly moved from side to side.

3. SPEED Button

Press to cycle through the three available fan speeds. Quiet, Standard and Turbo.

4. Timer Button

Press repeatedly to increase the running time in 30 minute intervals. The timer can be set between 30 minutes and 7.5 hours. Addition of the lights will show the time set. i.e. if the 4h and 1h lights are lit, the timer is set to 5 hours.

5. Colour Button

Press to cycle through the options for the ambient light - Off, White, Green, Purple or Blue. The light can be operated independently to the fan.

Remote Control



Your bladeless fan is supplied with a remote, which allows full control of all the units functions.

ON/OFF: Turns the fan On and Off

SPEED: Cycles between the fan speeds - Quiet, Standard and Turbo

TIMER: Press repeatedly to set the On timer in 30 minute intervals. The time set will be displayed on the unit.

SWING: Press to turn the Swing Function On and Off.

AMBIENT LIGHT BUTTONS - WHITE, GREEN, PURPLE AND BLUE: Press the appropriate button to turn on the colour of ambient light required. Press the same button again to turn off the ambient light.

Replacing the Batteries

The remote control is powered by a Lithium Button Cell Battery (CR2025). Should the remote become unresponsive, replace the battery following the instructions below:

1. Turn over the remote and press tab A to the right.
2. Slide out the battery tray B
3. Replace the battery with the same type, ensuring the positive side is facing upwards.

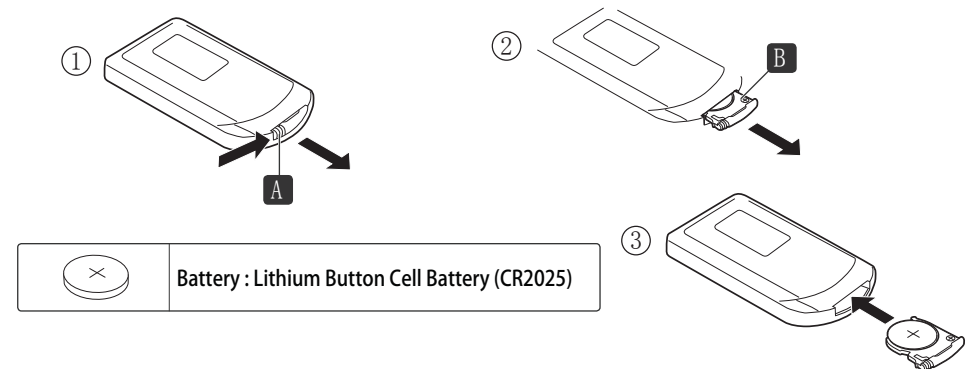

Maintenance

Cleaning and storage

ATTENTION: Please shut off the unit and unplug from the mains before cleaning or performing any maintenance.

Cleaning the surface

- Clean the fan with a duster or a soft wet cloth.
- Do not use chemical solvents (such as benzene, alcohol or gasoline) as they may cause irreversible damage. Make sure no water enters the control panel or fan motor.
- Do not run the unit until completely dry.
- Place the fan in its original box or cover the fan to protect it from dust.
- Store it in a cool dry place.

Troubleshooting

Do not repair or disassemble the unit by yourself, unauthorized repair attempts will invalidate the warranty and may cause bodily harm.

Issue	Possible Reason	Solution
No power	<ol style="list-style-type: none"> 1. Power cord is unconnected 2. There is no power from socket 3. The power switch is not on 	<ol style="list-style-type: none"> 1. Connect the power cord 2. Check socket is turned on 3. Turn the unit on
Odour emission from unit	New unit. When the unit is used for the first time the fan motor may produce and odour which will dissipate within a week of use	No action required
Strong vibrations and noise	<ol style="list-style-type: none"> 1. Fan is not used on a flat surface 2. Fan may be damaged 	<ol style="list-style-type: none"> 1. Place on a flat surface. May put an anti-vibration mat underneath 2. If fan is damaged discontinue use and contact service centre

If the above solutions do not resolve the problem please contact the service centre.

Appendix



Disposal: Do not dispose this product as unsorted municipal waste. Collection of such waste must be handled separately as special treatment is necessary.

Recycling facilities are now available for all customers at which you can deposit your old electrical products. Customers will be able to take any old electrical equipment to participating civic amenity sites run by their local councils. Please remember that this equipment will be further handled during the recycling process, so please be considerate when depositing your equipment. Please contact the local council for details of your local household waste recycling centres.

Technical Data

Model	: Orient Bladeless Fan
Fan Speeds	: 3
Cable length	: 1.7 meters
Rated Input	: 40 Watt
Fan Speed (r/min)	: 1200
Air Volume	: 50m ³ /hr
Power Supply	: 220-240V/50Hz
Net Weight	: 2.9 kg
Dimensions	: 571mm x 292mm x 171mm